

- NOTES:
- C XXX: Floor to ceiling height (mm)
 - D XXX: Floor to head door
 - B XXX: Floor to underside of beam
 - S XXX: Floor to sill height
 - H XXX: Floor to window head height
 - FL XXX: Floor finish level
 - (W.XX) Window number
 - (D.XX) Door number
 - RWP Rain water pipe
 - SVP Soil vent pipe
 - WP Waste pipe

- Demolished walls
- New walls
- Carpet flooring
Tretford "538 Silver Birch" roll
- Bathroom tile flooring 600x600x11
Pentagon "Real W LP" Lappato/Honed
- Kitchen tile flooring 600x600x11
Pentagon "Real G LP" Lappato/Honed
- Timber flooring
Havwoods "HW 964"
- Terrace tile flooring 600x600x18
Pentagon SIC798 PITCH 18mm GREY

- Where fire separating elements are penetrated by pipes, ventilation ducts and flues, the openings should be adequately fire stopped and provided with fire collars.

- New or altered elements of structure should be protected to 60 minutes of fire resistance.

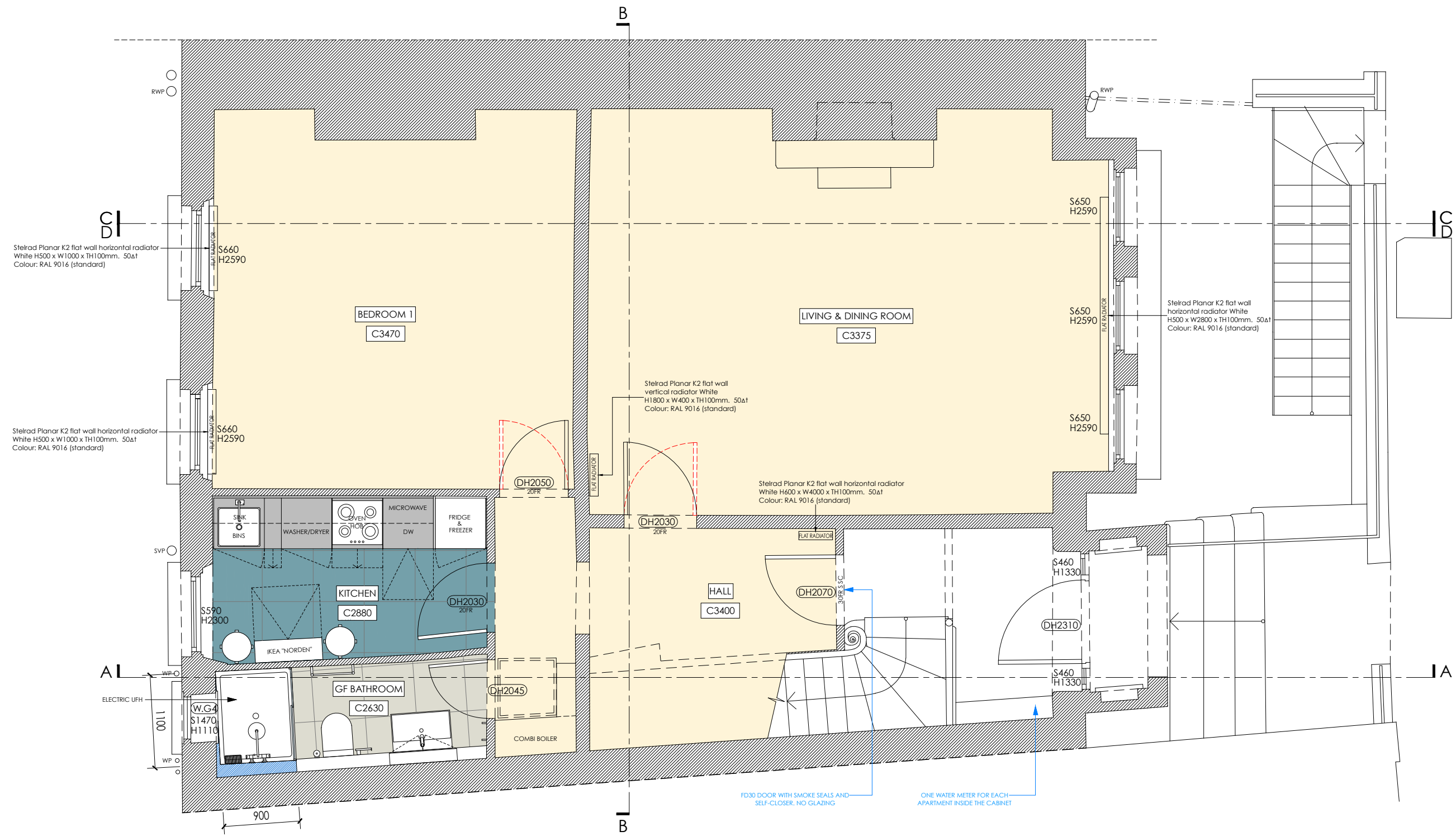

All dimensions shown on the plans are for general information and assistance in understanding the layout and scale. They are not all critical construction dimensions, but they do indicate the expected sizes and clearances. As always with drawings, please check setting out of any new work on site, compare to the noted dimensions and check with the architects if in doubt or if there is any significant deviation.

REVISIONS:

Scale 1:50 @ A3



APARTMENT DESIGN AND SPECIFICATIONS TO BE COMPLETED ONCE POSSESSED

GIFA: 68.62m²

21 WILLOW ROAD NW3 1TL - GENERAL ARRANGEMENT GROUND FLOOR

25/04/2016